

- ### NOTES
- ALL DISTURBED AREAS NOT OCCUPIED BY STRUCTURES, PAVING OR PLANTINGS SHALL BE GRADED AND SEEDED.
  - ALL SHRUB AND TREE PLANTINGS SHALL BE MULCHED WITH 3" CLEAN, PINE STRAW MULCH.
  - ALL PLANT BEDS TO BE EDGED WITH TYPICAL "V"-CHANNEL EDGE. SEE DETAIL, THIS SHEET. "V"-CHANNEL EDGE TO BE LOCATED ALONG OUTER PERIMETER OF SHRUB PLANTING AREAS WHERE SHRUBS ARE PLANTED IN GROUPINGS INSTEAD OF INDIVIDUAL LOCATIONS.
  - CONTRACTOR SHALL SUBMIT A SOIL SAMPLE FOR ANALYSIS BY WAKE COUNTY AGRICULTURAL EXTENSION SERVICE, AND SHALL APPLY FERTILIZER, LIME AND SOIL AMENDMENTS AS PER EXTENSION SERVICE RECOMMENDATIONS.
  - A MINIMUM OF FOUR INDIVIDUAL SOIL SAMPLES SHALL BE TAKEN THROUGHOUT THE SITE FOR OVERALL SOIL ANALYSIS.
  - ALL PLANTING AREAS TO RECEIVE 1 CY OF SOIL CONDITIONER FOR EACH 75 SF OF PLANT BED AREA. ACCEPTABLE SOIL CONDITIONERS SHALL BE PULVERIZED PINE BARK, PEAT MOSS OR SHREDDED/COMPOSTED LEAVES.
  - ALL SHRUB BEDS SHALL BE RAISED 6" - 8" ABOVE ADJACENT GRADE, AND FILLED WITH SOIL CONDITIONER, EXCEPT ALONG SIDES OF BUILDING, WHERE SOIL SHALL BE EXCAVATED TO 6" - 8" DEPTH TO ACCOMMODATE FOR SOIL CONDITIONER. MOUNDING THE SOIL CONDITIONER ABOVE GRADE IS NOT POSSIBLE DUE TO GRADING CONSTRAINTS.
  - CONTRACTOR TO FIELD VERIFY LOCATION OF EXISTING UTILITIES BEFORE BEGINNING OF LANDSCAPE INSTALLATION.
  - CONTRACTOR TO VERIFY QUANTITIES OF PLANTINGS AS SHOWN. PLANTINGS INDICATED ON PLANS SHALL PREVAIL OVER QUANTITIES INDICATED IN PLANT LIST IF DISCREPANCIES ARISE.
  - ALL PLANTS ARE TO BE THOROUGHLY "WATERED IN" THE SAME DAY AS PLANTED.
  - ALL CONTAINERIZED PLANTINGS ROOT BALLS SHALL BE SCARIFIED AS NEEDED INSTALLATION.
  - ALL PLANT HOLES SHALL BE TWICE THE WIDTH OF THE ACTUAL ROOT BALL SIZE.
  - REMOVE BURLAP FROM TOP OF ROOT BALL BEFORE BACKFILLING AROUND BALL IS COMPLETED.
  - ALL TREES WHICH ARE SMOOTH BARKED AT THE TIME OF PLANTING, AND HAVE MORE THAN 2" OF CLEAR TRUNK, SHALL BE WRAPPED.
  - ALL TREE WRAPPING SHALL EXTEND FROM THE TOP OF THE BACKFILL TO THE LOWERMOST TREE BRANCHES.
  - ALL TREES, WHEN PLANTED, SHALL HAVE THE SAME RELATIONSHIP TO FINISHED GRADE AS TO THE ORIGINAL PLANTING DEPTH.
  - THE SITE SHALL BE STABILIZED AND SEEDED PRIOR TO THE ISSUANCE OF A CERTIFICATE OF OCCUPANCY.
  - SEE LIGHTING PLAN FOR ACTUAL LIGHTING LOCATION AND SPECIFICATIONS.
  - PROVIDE ALL PLANTS SHOWN ON THE PLAN AND REPORT DISCREPANCIES BETWEEN PLAN AND PLANT LIST TO LANDSCAPE ARCHITECT.

### PLANT LIST

QUA.	KEY	BOTANICAL NAME	COMMON NAME	REMARKS	HEIGHT	ROOT	CALIPER
TREES							
10	WO	QUERCUS PHELLOS	WILLOW OAK			B&B	6" MIN
10	WO	QUERCUS PHELLOS	WILLOW OAK			B&B	2" MIN
7	IO	ILEX OPACA	AMERICAN HOLLY			B&B	2" MIN
7	IO	LAGERSTROEMIA INDICA	CREPE MYRTLE			B&B	2" MIN
SHRUBS							
40	BO	BUXUS SEMPERVIRENS	BOXWOOD		3' o.c.	36"	
20	DB	ILEX CORNUTA 'DWARF BURFORD'	DWARF BURFORD HOLLY		5' o.c.	36"	
21	AB	ABELIA 'EDWARD GOUCHER'	EDWARDS GOUCHER ABELIA		5' o.c.	36"	

### PLANTING REQUIREMENTS

VEHICULAR PLANTING AREA: 20,817 SF  
 1 TREE PER 2,000 SF VEHICULAR SURFACE AREA  
 10.4 TREES REQUIRED  
 10 TREES PROVIDED

1 SHRUB PER 500 S.F. VEHICULAR SURFACE AREA  
 41.8 SHRUBS REQUIRED  
 42 SHRUBS PROVIDED

15' STREET YARD - HILLSBOROUGH STREET  
 168.22 L.F.  
 1 6" CAL. TREE PER 50 L.F. REQUIRED  
 3.36 TREES REQUIRED  
 4 TREES PROVIDED

15' STREET YARD - BASHFORD ROAD  
 280.68 L.F.  
 1 6" CAL. TREE PER 50 L.F. REQUIRED  
 5.6 TREES REQUIRED  
 6 TREES PROVIDED

30' TRANSITIONAL PROTECTIVE YARD - SOUTH BUFFER  
 LOW IMPACT USE (ZONED R-4)  
 ADJACENT TO LOW RESIDENTIAL DENSITY  
 30' TRANSITIONAL PROTECTIVE YARD REQUIRED.  
 170.65 L.F.  
 4 SHADE TREES PER 100 L.F. REQUIRED  
 6.84 TREES REQUIRED  
 7 TREES PROVIDED

4 UNDERSTORY TREES PER 100 L.F. REQUIRED  
 6.84 TREES REQUIRED  
 7 UNDERSTORY TREES PROVIDED

MIN. 40 SHRUBS @ 36" HT. PER 100 L.F. REQUIRED  
 68.4 TREES REQUIRED  
 70 SHRUBS PROVIDED

WEST BUFFER  
 HIGH IMPACT USE (OUTDOOR STORAGE OF VEHICLES)  
 ADJACENT TO HIGH IMPACT USE  
 NO PROTECTIVE YARD REQUIRED.

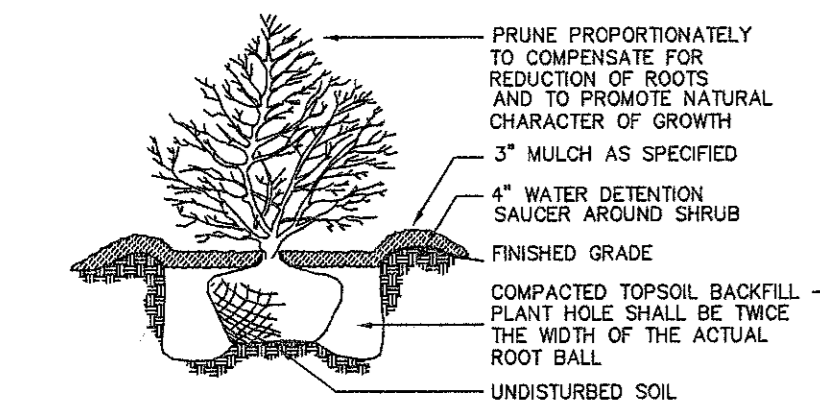
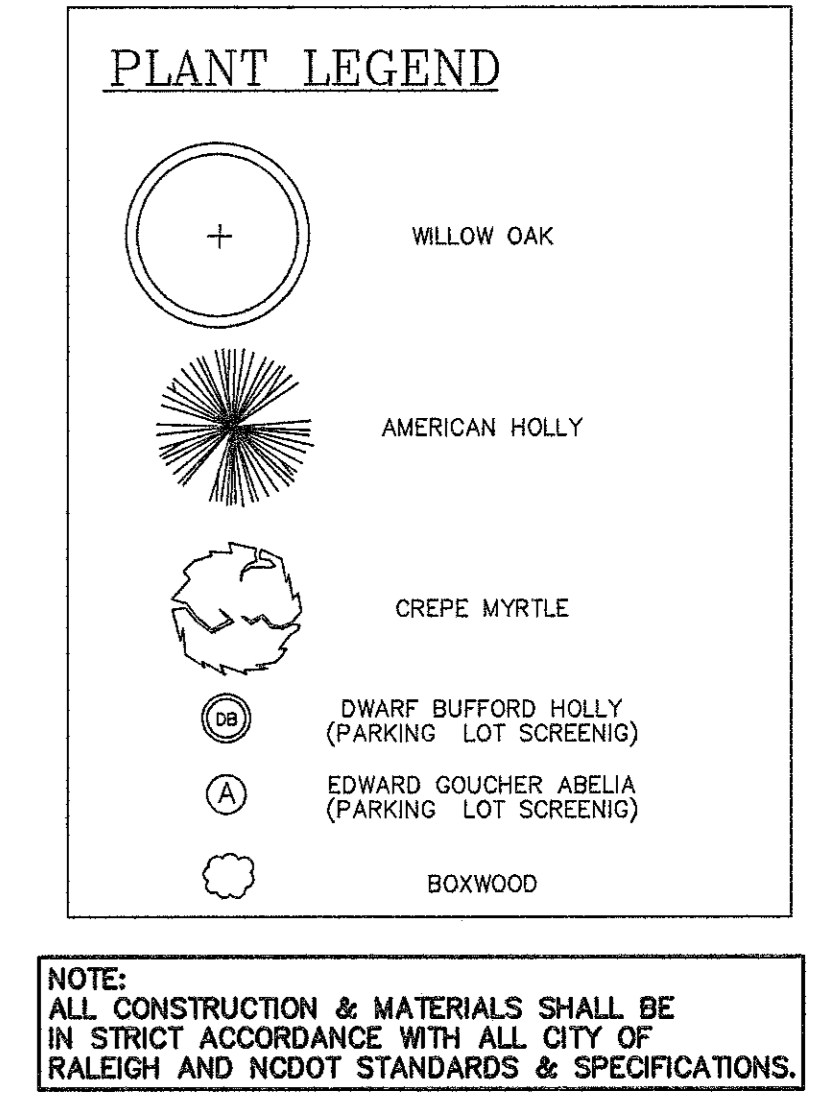

TYP. SHRUB PLANTING DETAIL  
NOT TO SCALE

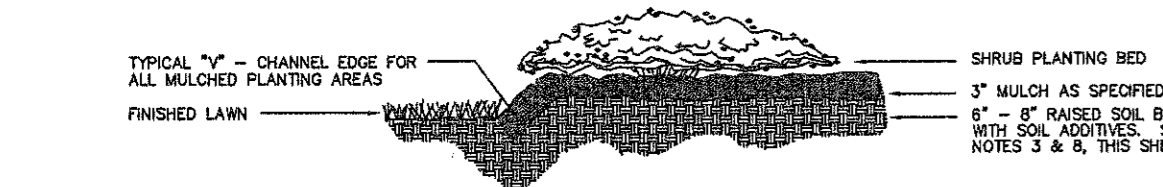

TYP. "V"-CHANNEL EDGE DETAIL  
NOT TO SCALE

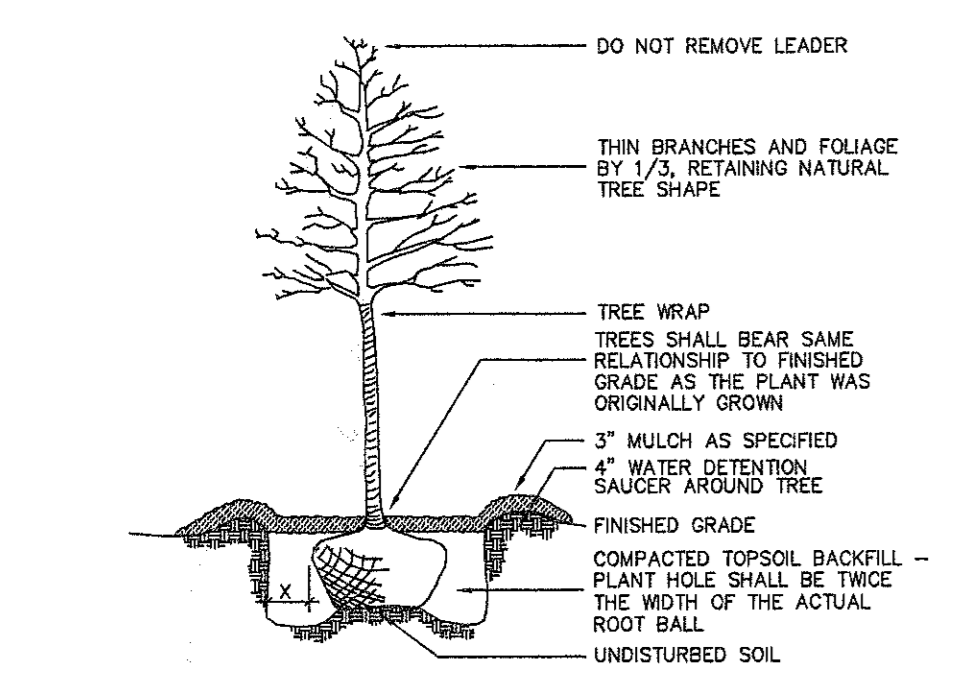

TYP. TREE PLANTING DETAIL  
NOT TO SCALE

BHOLE, LLC  
 DB 10132 PG 931  
 BM 2003 PG 669  
 BM 1984 PG 414  
 PIN 0774-51-9940  
 ZONED NB

DAVID MARTIN CONTRACTOR, INC.  
 DB 14346 PG 1602  
 PIN 0774-61-1434  
 ZONED R-4

PRELIMINARY DRAWING  
 DO NOT USE FOR CONSTRUCTION

OWNER/DEVELOPER:  
 DAVID MARTIN CONTRACTOR, INC.  
 1201 BUCK JONES ROAD  
 RALEIGH, NC 27606-3326  
 (919) 467-8118

SP-51-12 SHEET 4

### PRELIMINARY LANDSCAPE PLAN 6 BASHFORD ROAD PROPOSED USE CAR LOT

RALEIGH TOWNSHIP	WAKE COUNTY	NORTH CAROLINA
OWNER DAVID MARTIN CONTRACTOR, INC. ZONED NB		
DATE 09/14/2012	DRAWN RIS	JOB NO. 12-014
SCALE 1" = 20'	SURVEYED REM	DWG BASHFORD
REVISIONS: 6-25-13	PIN 0774-61-1828	
9/16/13		

THOMPSON & ASSOCIATES, P.A.  
 1145 EXECUTIVE CIRCLE  
 SUITE D UNIT 2  
 CARRIAGE HOUSE  
 RALEIGH, NC 27605-3286  
 FAX (919) 289-1585  
 C-0343

